

Double Light 2882

Features

- Solid brass construction
- Single -post, double light design
- UL listed for damp locations (U.S. and Canada)
- ADA compliant
- Max. 100 Watt Type A-19 bulb (not supplied) required
- May be installed vertically or horizontally
- Complements Surface product series



Codes / Standards Compliance

Meets or exceeds the following at date of manufacture:

- UL 1598
- ADA
- All applicable US Federal and State material regulations

Colors / Finishes

- PC: Polished Chrome
- SN: Satin Nickel

Specified Model

Model	Description	Colors / Finishes
2882	Double Light, Satin Etched Cased Opal*	<input type="checkbox"/> PC <input type="checkbox"/> SN

Replacement Parts

Model	Description	Colors / Finishes
3681-G-O	Replacement Glass Shade	<input type="checkbox"/> Satin-Etched Cased Opal Glass

* Installation Note (Electrician/Wall-finisher): This light uses a non-standard size backplate. This light is designed to be installed onto a standard switch box as follows: (1) vertically installed for a vertical light orientation and (2) horizontally for a horizontal light orientation. Maximum width (vertical) or height (horizontal) of finished opening is 2-1/2".

Product Specification: Add "Color / Finish" Suffix to Model Number Below

The Double Light shall incorporate solid brass construction and a satin-etched cased opal glass shade. Double Light shall complement Ginger Surface product series. Double Light shall be Ginger Model 2882/_____.

2882

Product Dimensions *(units are in inches)*

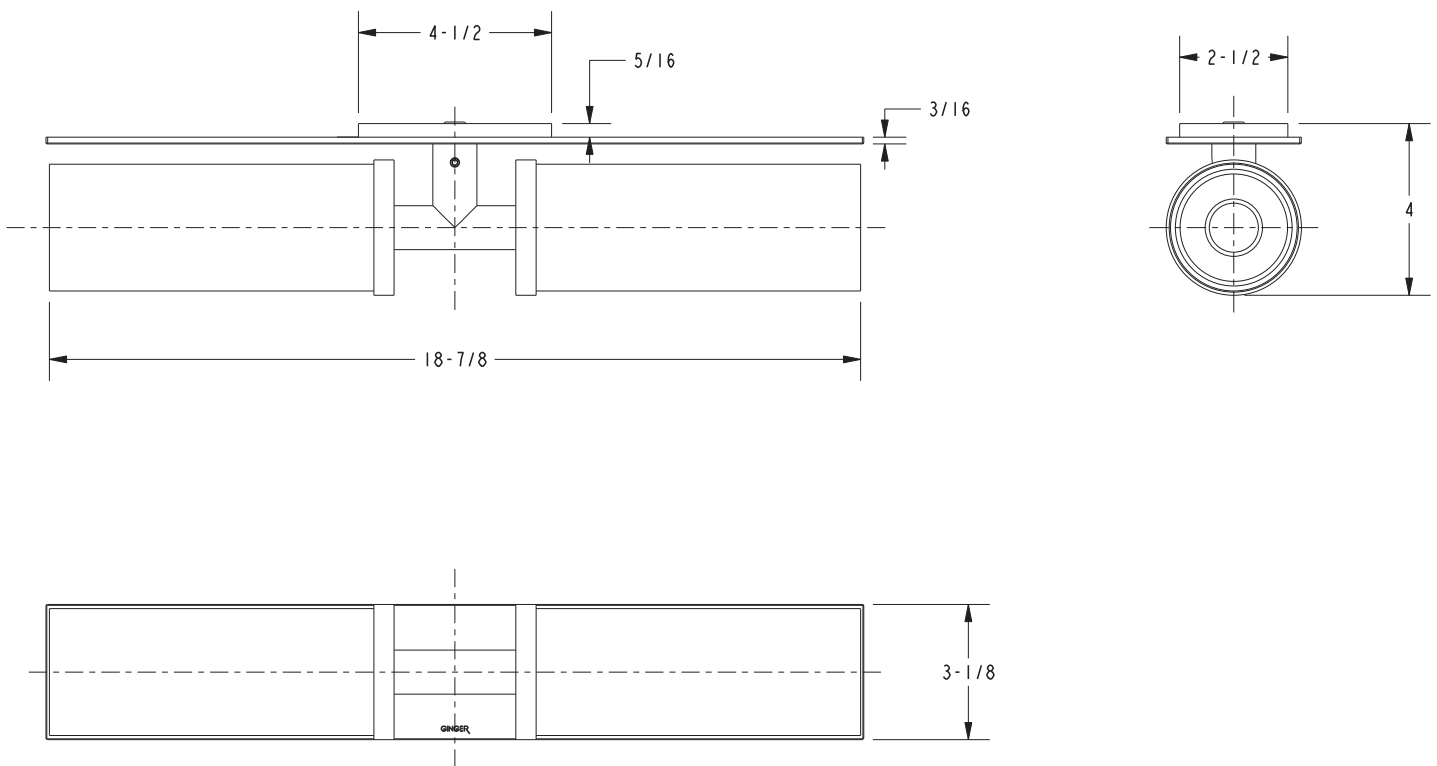

ADA compliant 